

**SFCB /UTILITIES VESSEL****General**

Owners	:	
IMO No.	:	
Official Number	:	
Builder	:	
Built	:	2013
Flag / Port of Registration	:	Malaysia / Port Klang
Call sign	:	9MQH8
Classification	:	Bureau Veritas (BV)

Dimension

Tonnage	- GT	: 238 T
	- NT	: 71 T
Length	- Overall	: 40.25 m
Beam	- Moulded	: 7.48 m
Depth		: 3.23 m
Draft		: 2.30 m

Capacities

Cargo Deck Space	Deck	: 6.00 m x 19.00 m (114.00m ²)
Strength		: 2 T/m ²
Reefer Point		: 2 nos on deck (220/440 VAC)
Portable Water Tanks		: 30 m ³
Fuel Oil Tanks		: 61.8 m ³
Lubrication Oil		: 200 litres
Cargo Weight.	- Maximum	: Approx. 45 T
Deadweight.	- Maximum	: 210 T
	- Light displacement	: 103 T

Propulsion

Main Engine	- Type	: 2 x Cummins KTA38M2 1 x Cummins KTA50M2
	- BHP	: 2 x 1350 BHP & 1x1800BHP Total: 4500 BHP (3350 kW)
Propellers		: 3 x Fixed Pitch Propeller (FPP)
Bow Thruster		: 2 MT lateral thrust
Controls		: 2 control stands
Starter		: Electrical
Reduction Gear & Ratio		: Twin Disc, MG 6690 & 6848 SC, 2.47:1
Speed / Consumption - Maximum		: 27 Knots / Approx 861 ltr/hr
	- Cruising	: 26.5 knots @ 85% MCR/Approx 744 ltr/hr
	- Genset	: Approx 25 ltr/hr
Generators	- Type	: 2 x CUMMINS BT 5.9 D(M)
	- kW	: 2 x 80 kW
	- Voltage	: 415 V
	- Phase	: 3 phases
	- Hz	: 50 Hz

Accommodation

Cabin/ Berth	: 5 nos / 10 units (4 berths x 1 nos) (2 berths x 2 nos) (1 berth x 2 nos)
Crew Passengers	: 10 pax : 58 pax (Business Class inclined seatwith individual hand rest, Fully Air- conditioning.

Life Saving Equipment

Water Curtain	: All around accommodation
Inflatable Life Rafts	: 20 men x 8 nos.
Rescue Boat	: 6 men x 1 Semi-Rigid rescue boat c/w 25hp outboard engine
Ring Buoys	: 8 nos
Man Over Board Marker	: 2 nos
Life Jackets / Work Vests	: 68 nos,(SOLAS approved) / 12
SART	: 2 nos
EPIRB	: 1 no
Line Throwing Apparatus	: 1 set (4 projectiles & 4 lines) nos

Fire Fighting Equipment

Fire Extinguishers	: As per SOLAS
Fireman Outfit	: 2 nos
Breathing Apparatus	: 2 sets of SCBA

Navigation & Communication

As per SOLAS

Others

Bilge Pump / Ballast Pump	: 30 m ³ /hr @ 54 m head
Fire Pump	: 30 m ³ /hr @ 54 m head Fresh Water
Transfer Pump	: 13.5 m ³ /hr @ 55 m head
Fuel Transfer Pump	: 13.5 m ³ /hr @ 54 m head
Anchor Weight	: 255kg HHP
Anchor Windlass	: DOUBLE GYPSOY TWIN WARPING HEAD
Stove (cooker)	: 1 no.
Dry Store	: 1 x 4 m ³
Fridge	: 1 x 4 m ³
Freezer	: 1 x 3 m ³
Washing machine	: 1 x 10kg
Dryer	: 1 x 10kg
Rescue Zone	: 2
Hospital / Owner Cabin	: 1

PRINCIPAL PARTICULARS		
LENGTH O.A.	40.37	m
BEAM MOULDED	7.5	m
DEPTH MOULDED	3.2	m
GRT	238	
DRAFT MAX BL	1.72	m
DRAFT MAX PROP	2.35	m
CLEAR DECK	117	m ²
FUEL OIL	62	m ²
LUBE OIL	0.8	m ²
FRESH WATER	28.3	m ²
BLACK WATER	0.5	m ²
GREY WATER	1.0	m ²
PASSENGERS	58	
CREW	10	
DECK STRENGTH	2.0	t/m ²
MAX DEAD WEIGHT	95	t
PROPULSION	4500	bhp
BOW THRUSTER	2 X 150	bhp
SPEED (85%MCR, 50dwt)	25	kts

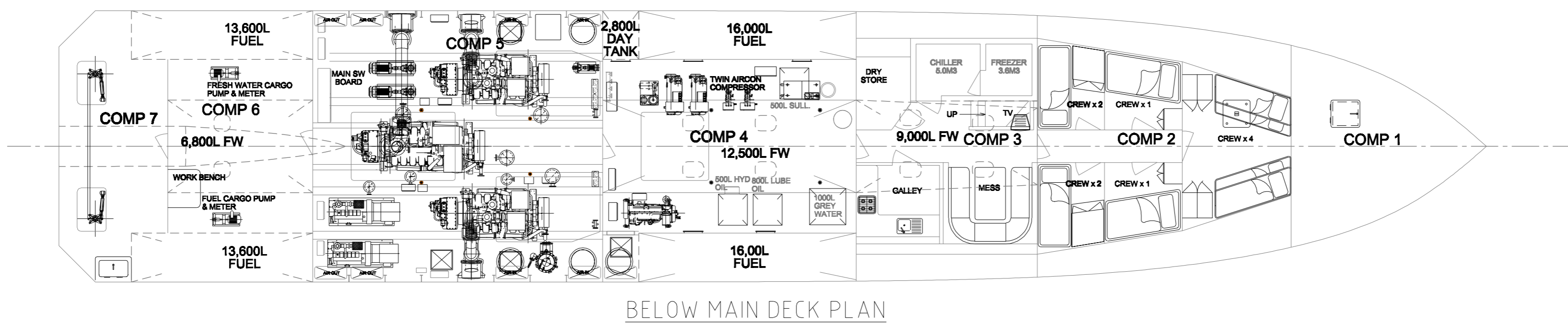
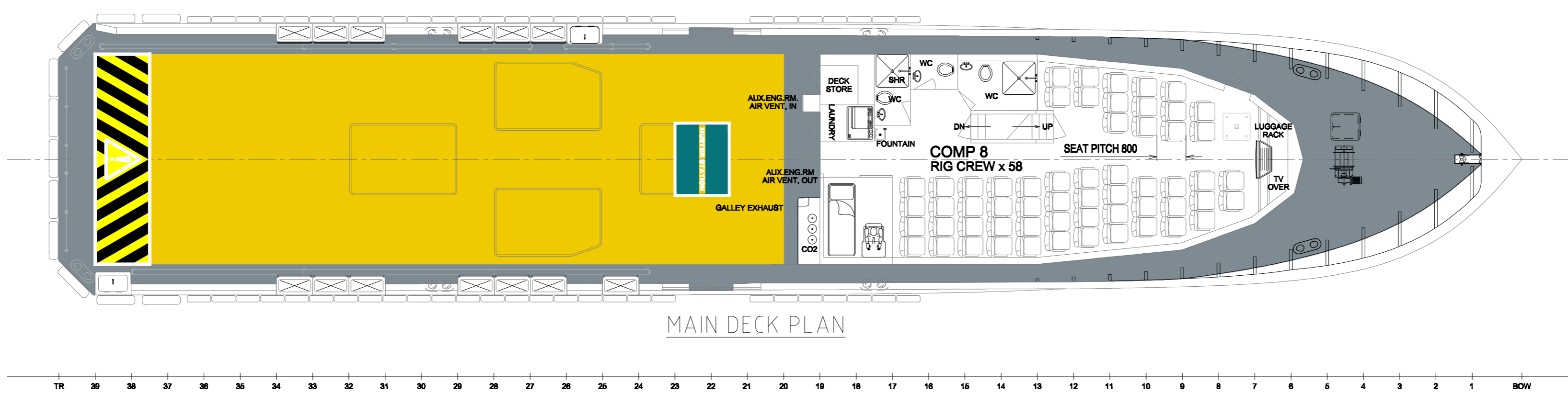
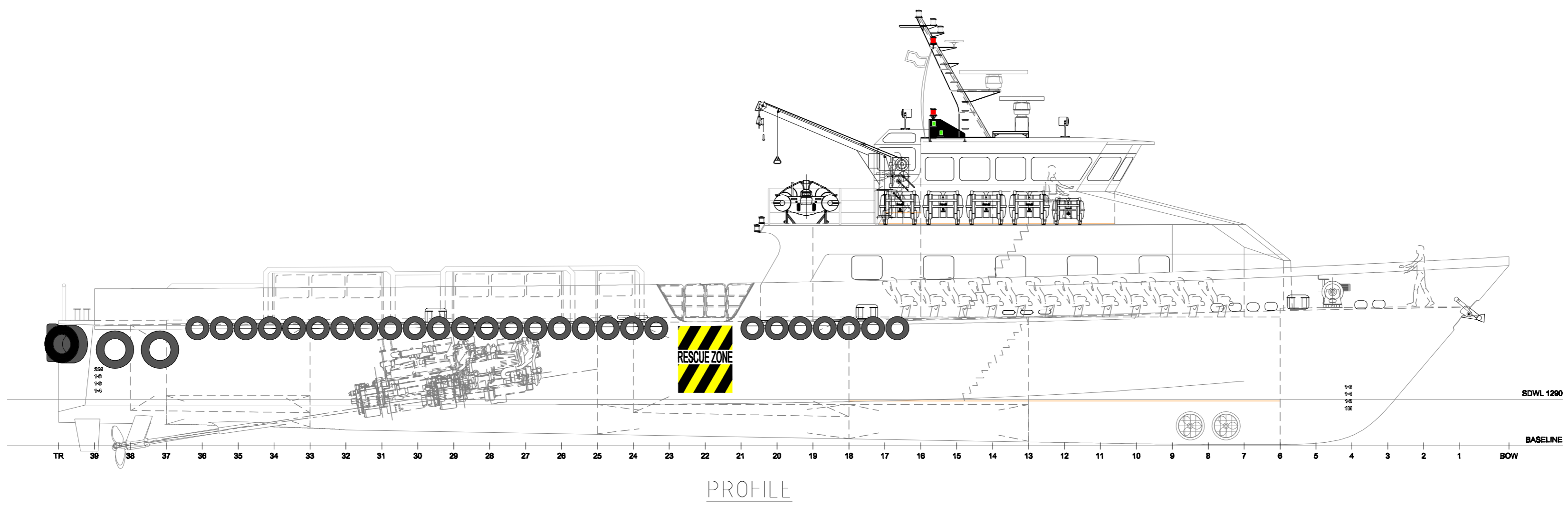
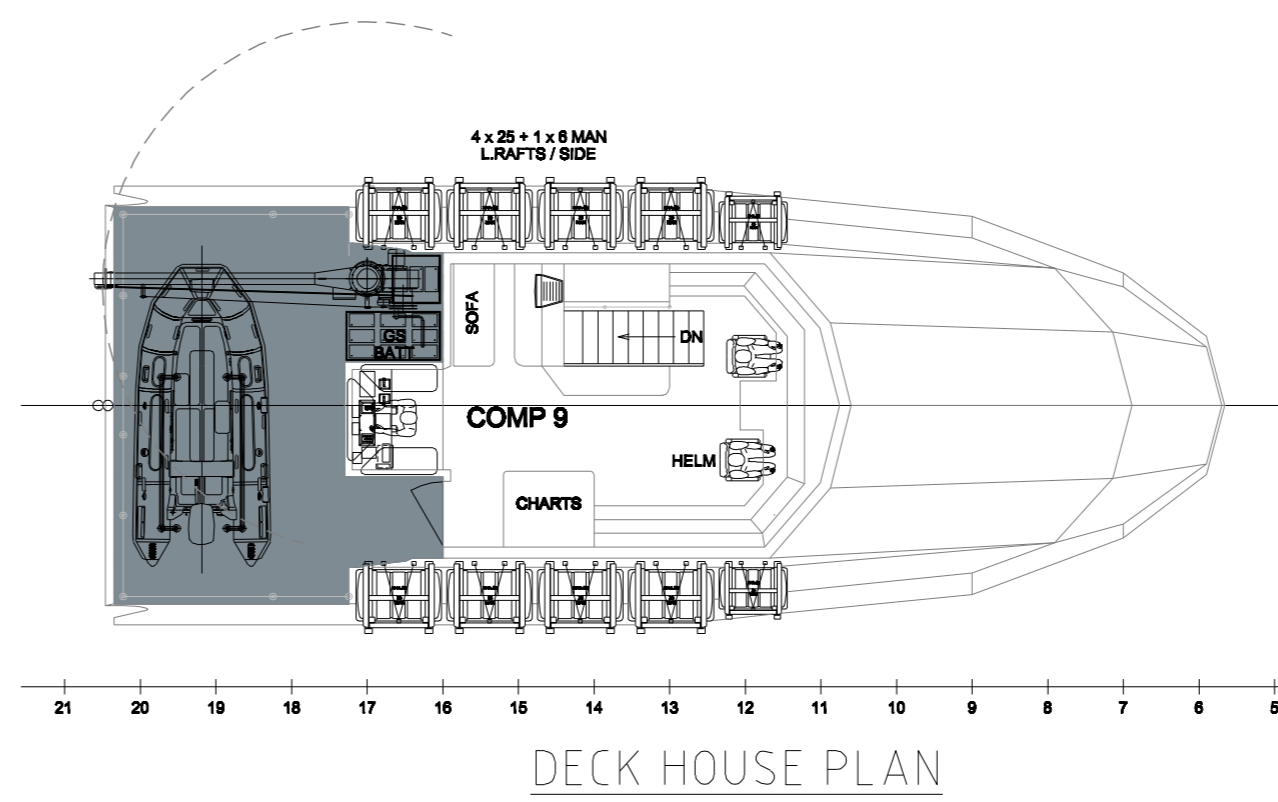
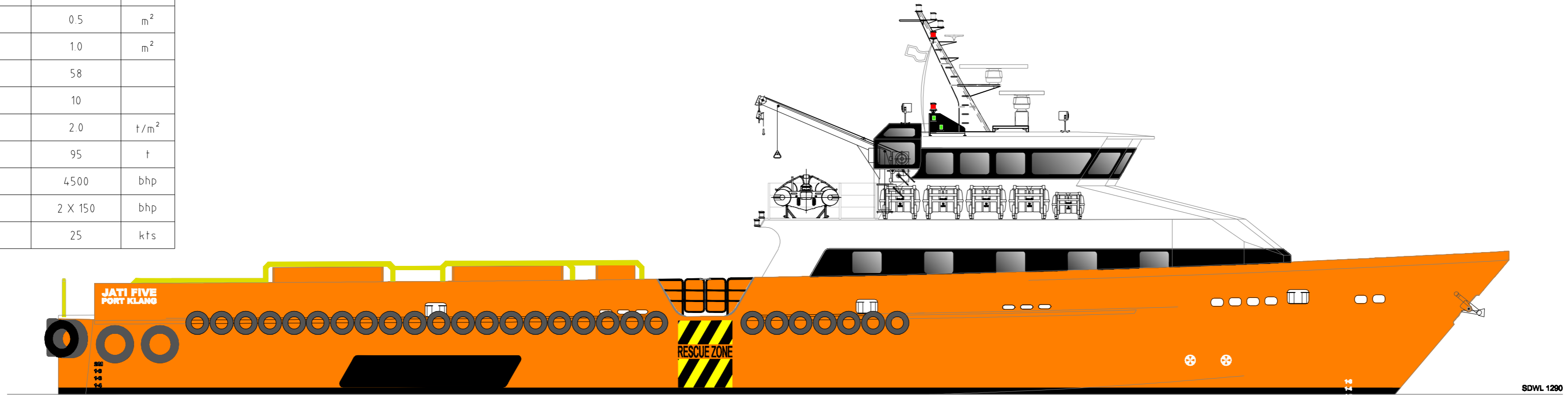

FOR APPROVAL

NOTES:

- 1 DRAFT MARKS TO CORRELATE WITH FREEBOARD ASSIGNMENT
- 2 MAXIMUM DEAD WEIGHT TO CORRELATE WITH FINAL STABILITY BOOKLET
- 3 BOUNDARIES AND BULKHEAD INSULATION ARRANGEMENT AND DETAILS KINDLY REFER TO FIRE AND SAFETY PLAN
- 4 DAMAGE STABILITY WILL BE SUBMITTED TO COMPLY WITH MSC.235(82)
5. DOOR DETAILS ARE TO BE SUBMITTED.

TITLE		GENERAL ARRANGEMENT	
PROJECT	40.37M RIG PERSONNEL / UTILITY VESSEL	HULL NO.	H354
DRAWING REF.	S578-15-001_A	SHEET NO.	1 OF 1
SCALE	1:100 OR AS SHOWN	DATE	25/02/13
DRAWN	C. CASTILLO	CHECKED	G. DANIEL
APPROVED	G. DANIEL		

REV	REVISION DETAILS	DATE	DRN	CHECKED	APPROVED
A	FOR APPROVAL	28/02/13	C. CASTILLO	G. DANIEL	G. DANIEL